

Unilift KP 150, KP 250, KP 350

Installation and operating instructions



Other languages

<http://net.grundfos.com/qr/i/96894217>

be
think
innovate

GRUNDFOS 

English (GB) Installation and operating instructions

Original installation and operating instructions

CONTENTS

	Page
1. Symbols used in this document	2
2. Unilift KP pumps	2
3. Applications	3
3.1 Pumped liquids	3
4. Functions	3
5. Operating conditions	3
5.1 Sound pressure level	3
6. Installation	4
6.1 Space requirements	4
6.2 Pump positions	4
6.3 Pipe connection	4
6.4 Start/stop level	5
6.5 Electrical connection	5
7. Operation	6
7.1 Unilift KP-A	6
7.2 Unilift KP-AV	6
7.3 Unilift KP-M	6
8. Maintenance	7
8.1 Cleaning the pump	7
8.2 Service	8
9. Fault finding the product	9
10. Disposal	9



Warning

Prior to installation, read these installation and operating instructions. Installation and operation must comply with local regulations and accepted codes of good practice.

Warning

The use of this product requires experience with and knowledge of the product.



Persons with reduced physical, sensory or mental capabilities must not use this product, unless they are under supervision or have been instructed in the use of the product by a person responsible for their safety.

Children must not use or play with this product.

1. Symbols used in this document



Warning

If these safety instructions are not observed, it may result in personal injury.



Caution

If these safety instructions are not observed, it may result in malfunction or damage to the equipment.



Note

Notes or instructions that make the job easier and ensure safe operation.

2. Unilift KP pumps

Grundfos Unilift KP pumps are available in these versions:

- Unilift KP-A with float switch (automatic operation)
- Unilift KP-AV with vertical level switch (automatic operation)
- Unilift KP-M without level switch (manual operation).

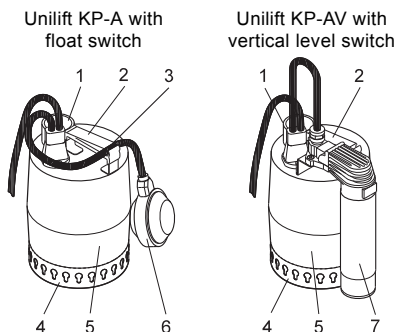

Fig. 1 Pumps with level switch

Pos.	Description
1	Outlet, Rp 1 1/4
2	Handle
3	Cable clamp
4	Inlet strainer
5	Pump sleeve
6	Float switch
7	Vertical level switch

TM01 1107 1205

3. Applications

Unilift KP 150, KP 250 and KP 350 are single-stage submersible pumps designed for the pumping of grey wastewater.

The pump can pump water with a limited content of solid particles up to 10 mm diameter without being clogged or damaged.

The pump can be used for automatic as well as manual operation and is suitable for both permanent and temporary use.

The pump is suitable for these applications:

- pumping in drain tanks
- pumping of wastewater from washing machines, baths, sinks, etc. from low-lying parts of buildings up to sewer level
- drainage of flooded cellars or buildings
- pumping in surface water drain tanks with inlets from roof gutters, tanks, tunnels, etc.
- emptying of swimming pools, ponds or fountains.



Warning

Do not use the pump in or at swimming pools, garden ponds, etc. when there are persons in the water.

3.1 Pumped liquids

The pump is not suitable for these liquids:

- liquids containing long fibres
- flammable liquids (oil, petrol, etc.)
- aggressive liquids.

Note

The pump contains approx. 70 ml of non-toxic rotor liquid which will be mixed with the pumped liquid in case of a leak.

4. Functions

Unilift KP-A

Automatic on/off operation via a float switch.

Unilift KP-AV

Automatic start/stop operation via vertical level switch.

Unilift KP-M

Manual operation via external on/off switch.

5. Operating conditions

Liquid temperature

Minimum 0 °C.

The maximum liquid temperature depends on the rated voltage of the pump. See the table below.

Voltage	Maximum liquid temperature [°C]
1 x 100 V, 50 Hz	35
1 x 110 V, 50 Hz	40
1 x 100-110 V, 50 Hz ¹⁾	40
1 x 220-230 V, 50 Hz	50
1 x 220-240 V, 50 Hz, 50 Hz ¹⁾	50
1 x 230-240 V, 50 Hz	50
1 x 100 V, 60 Hz	35
1 x 115 V, 60 Hz	50 ²⁾
1 x 220 V, 60 Hz	40
3 x 200 V, 50 Hz	35
3 x 380-400 V, 50 Hz ¹⁾	50
3 x 380-415 V, 50 Hz	50
3 x 200 V, 60 Hz	35

At intervals of at least 30 minutes, the pumps may, however, run at maximum 70 °C for periods not exceeding 2 minutes.

¹⁾ Voltage variant for Unilift KP 350.

²⁾ KP 350: 45.

Storage temperature

-20 - +70 °C.

Installation depth

Maximum 10 m below liquid level.

Caution

Always have at least 3 m free cable above liquid level. This limits installation depth to 7 m for pumps with 10 m cable and to 2 m for pumps with 5 m cable.

Caution

Pumps with 3 m cable are for industrial applications only.

5.1 Sound pressure level

The sound pressure level of the pump is lower than the limiting values stated in the EC Council Directive 2006/42/EC relating to machinery.

6. Installation

Do not install the pump hanging from the electric cable or the outlet pipe.

Caution Never lift the pump by the power supply cable. Lift the pump using the pipe/hose or a rope secured to the pump handle.

Note According to EN 60335-2-41/A2:2010, this product with 5 metres of mains cable may be used only for indoor applications.

6.1 Space requirements

6.1.1 Unilift KP-A

If the pump is installed in a tank, the minimum dimensions of the tank must be as shown in fig. 2 to ensure free movability of the float switch. Figure 3 shows a pump with vertical level switch.

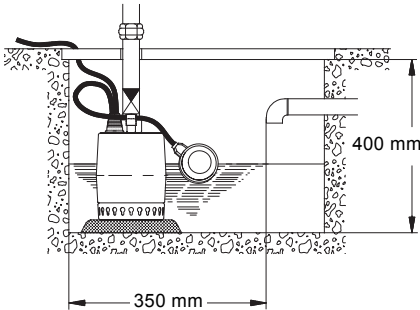

Fig. 2 Minimum tank dimensions, Unilift KP-A

TM03 4445 2106

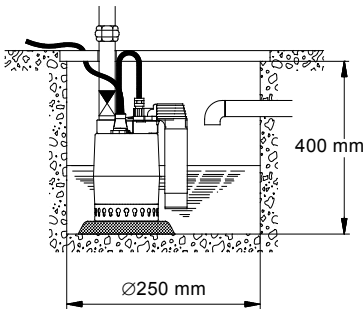

Fig. 3 Minimum tank dimensions, Unilift KP-AV

TM01 1109 1098

6.1.2 Unilift KP-M

The pump requires no more space than the physical dimensions of the pump. See page 10.

6.2 Pump positions

Unilift KP-A and Unilift KP-M can be used in vertical position with the outlet pointing upwards. The pumps may also be used in horizontal or tilted position with the outlet as the highest point. See fig. 4.

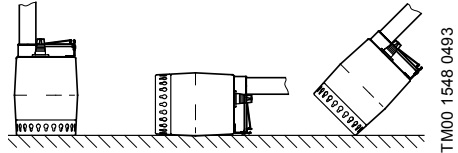

Fig. 4 How to place Unilift KP-A and Unilift KP-M

TM00 1548 0493

Caution Always place Unilift KP-AV in vertical position.

Place the pump so that the inlet strainer is not covered in sludge, mud or similar materials. You can ensure this by placing the pump on bricks, an iron plate, or similar. See fig. 5.

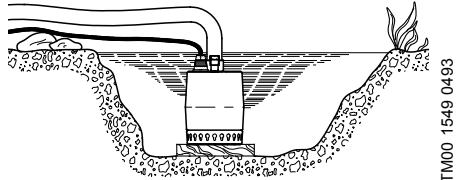

Fig. 5 Pump placed on a plate

TM00 1549 0493

6.3 Pipe connection

Fit the outlet pipe or hose in the Rp 1 1/4 outlet. Steel pipes can be screwed directly into the pump outlet.

In a permanent installation, fit a union to the outlet pipe to facilitate mounting and removal. If a hose is used, fit a hose union.

Caution The pump must not be installed hanging from the outlet pipe.

In a permanent installation with level switch, fit a non-return valve to outlet pipe or hose.

6.4 Start/stop level

6.4.1 Unilift KP-A

The level difference between start and stop can be adjusted by changing the free cable length between the pump handle and the float switch.

- A long free cable length gives fewer starts/stops and a large level difference.
- A short free cable length gives frequent starts/stops and a small level difference.

To enable the float switch to start and stop the pump, the free cable length (L) must be minimum 70 mm and maximum 150 mm. See fig. 6.

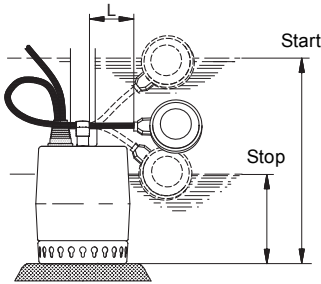

Fig. 6 Start/stop levels, Unilift KP-A

TM03 4446 2106

Pump type	Cable length (L) min. 70 mm		Cable length (L) max. 150 mm	
	Start [mm]	Stop [mm]	Start [mm]	Stop [mm]
Unilift KP 150 A	290	140	335	100
Unilift KP 250 A				
Unilift KP 350 A	300	150	345	110

6.4.2 Unilift KP-AV

The level difference for pumps with vertical level switch cannot be adjusted. Start/stop levels appear from fig. 7.

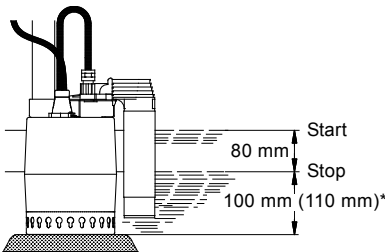

Fig. 7 Start/stop levels KP-AV

TM01 1108 3797

- * Unilift KP 350.

6.5 Electrical connection

The electrical connection must be carried out in accordance with local regulations and standards.

Check that the mains voltage and frequency correspond to the values stated on the pump nameplate.

Warning



The pump must be connected to an external mains switch with a minimum contact gap of 3 mm in all poles.

As a precaution, all pumps must be connected to a socket with earth connection.

Warning



The protective earth of the socket outlet must be connected to the protective earth of the pump. The plug must therefore have the same PE connection system as that of the socket outlet. If not, use a suitable adapter.

Warning



The installation must be fitted with an earth leakage circuit breaker (ELCB) with a tripping current less than 30 mA.

The pump motor incorporates thermal overload protection and requires no additional motor protection.

If the motor is overloaded, it will stop automatically.

Note

When the motor has cooled to normal temperature, it restarts automatically.

Motors for Unilift KP 350, 3 x 200 V, 50 Hz, must be connected to a motor-protective circuit breaker.

Three-phase pumps with float switch (Unilift KP-A) must be connected to the mains supply by means of a contactor. See fig. 8.

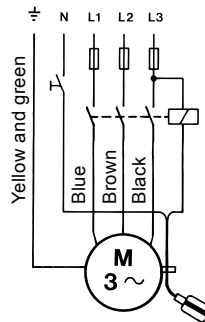

Fig. 8 Wiring diagram

TM00 2011 3793

8. Maintenance

Under normal operating conditions, the pump is maintenance-free.

If the pump has been used for liquids other than clean water, flush it through with clean water immediately after use.

Warning

For safety reasons the inlet strainer must always be fitted to the pump during operation.



Never dismantle the pump unless the power supply has been switched off.

Be careful during dismantling as you will get access to sharp edges, etc., which may cause cuts. Wear protective gloves.

8.1 Cleaning the pump

Warning



Before starting any work on the product, make sure that the power supply has been switched off and that it cannot be accidentally switched on.

If the pump delivers too little water due to deposits or the like, dismantle and clean the pump:

1. Disconnect the power supply.
2. Drain the pump.
3. Remove the inlet strainer.
 - Press a screwdriver in between the pump sleeve and the strainer and press hard. Do the same in several places along the strainer until it is pried loose and can be removed. See fig. 10.

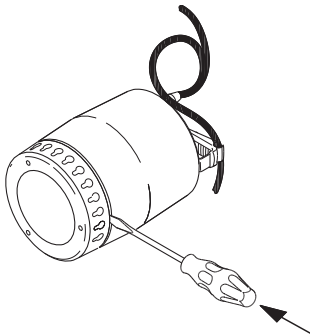

Fig. 10 How to remove the inlet strainer

4. Clean the inlet strainer and fit it.

If the pump still delivers too little water, dismantle the pump further.

1. Disconnect the power supply.
2. Remove the inlet strainer. See point 3 above.
3. Turn the pump housing 90 ° counter-clockwise using a screwdriver. See the arrow on the pump housing.
4. Pull off the pump housing. See fig. 11.

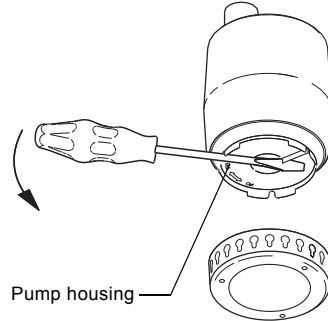

Fig. 11 How to remove the pump housing

5. Clean and flush the inside of the pump to remove possible impurities between motor and pump sleeve.
6. Clean the impeller. See fig. 12.

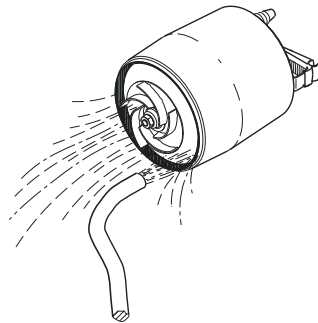

Fig. 12 How to flush the pump

7. Check that the impeller can rotate freely. If not, remove the impeller. See point 6.

TM03 1167 1205

TM03 1169 1205

TM03 1168 1205

8. Unscrew the nut (cross width 13 mm) from the motor shaft. Use a screwdriver to prevent the impeller from turning. See fig. 13.

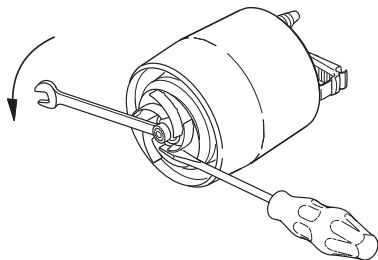

Fig. 13 How to remove the impeller

9. Clean the impeller and clean around the shaft.
 10. Check the impeller, the pump housing and the sealing part. If necessary, replace defective parts.
 11. Assemble the pump in the reverse order of the dismantling.

Before and during the mounting of the pump housing, check that the sealing part is fitted correctly. See fig. 14.

Caution

Moisten the sealing part with water to ease the fitting.

8.2 Service

The impeller, the inlet strainer and the non-return valve are replaceable.

Order numbers for the ordering of service kits and contents of service kits appear from the tables below and fig. 14.

Pump type	Part number
Impeller kit	
Unilift KP 150	015778
Unilift KP 250	015779
Unilift KP 350	015787
Inlet strainer	
Unilift KP 150	
Unilift KP 250	96548064
Unilift KP 350	96548066
Non-return valve	
Unilift KP 150	
Unilift KP 250	15220
Unilift KP 350	

Service kits	Pos.	Designation	Quantity
Impeller kit	A	Impeller	1
	B	Nut	1
	C	Sealing part	1
Inlet strainer	D	Inlet strainer	1

If other pump components are damaged or defective, contact the pump supplier.

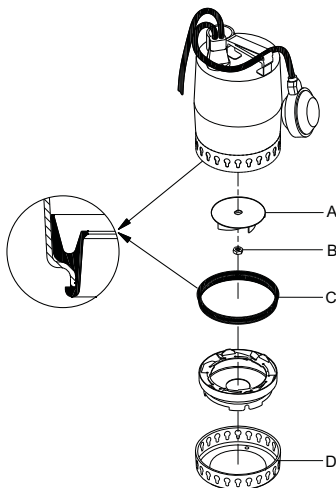

Fig. 14 Service parts

Note

The cable and level switch must be replaced by an authorised Grundfos service workshop.

TM03 1170 1205

TM03 1166 1205

9. Fault finding the product



Warning

Before starting any work on the product, make sure that the power supply has been switched off and that it cannot be accidentally switched on.

Fault	Cause	Remedy
1. The motor does not start.	a) No power supply.	Connect the power supply.
	b) The pump was stopped by the level switch.	Unilift KP-A: Start the pump by lifting the float switch. See section 7.1 Unilift KP-A .
	c) The fuses have blown.	Replace the fuses.
	d) The thermal switch has tripped.	Wait until the thermal switch cuts in again or let the pump cool off. See section 6.5 Electrical connection .
2. The thermal switch trips after a short time of operation.	a) The liquid temperature is too high. See section 5. Operating conditions .	The pump starts automatically after sufficient cooling.
	b) The pump is partly blocked by impurities.	Clean the pump. See section 8. Maintenance .
	c) The pump is mechanically blocked.	Remove the blockage. See section 8. Maintenance .
3. The pump runs but delivers too little water.	a) The pump is partly blocked by impurities.	Clean the pump. See section 8. Maintenance .
	b) The outlet pipe/hose is partly blocked.	Check and clean the non-return valve, if fitted.
	c) Wrong direction of rotation in three-phase pumps. See section 6.5.1 Checking the direction of rotation .	Reverse the direction of rotation.
4. The pump runs but delivers no water.	a) The pump is blocked by impurities.	Clean the pump. See section 8. Maintenance .
	b) The outlet pipe/hose is partly blocked.	Check and clean the non-return valve, if fitted.
	c) The liquid level is too low. During normal operation, the inlet strainer must be covered by the pumped liquid.	Lower the pump deeper into the liquid or adjust the level switch.
	d) Unilift KP-A: The free cable length of the float switch is too long.	Reduce the free cable length. See section 6.4 Start/stop level .

10. Disposal

This product or parts of it must be disposed of in an environmentally sound way:

1. Use the public or private waste collection service.
2. If this is not possible, contact the nearest Grundfos company or service workshop.

Subject to alterations.

Appendix

Dimensions

Unilift KP-AV

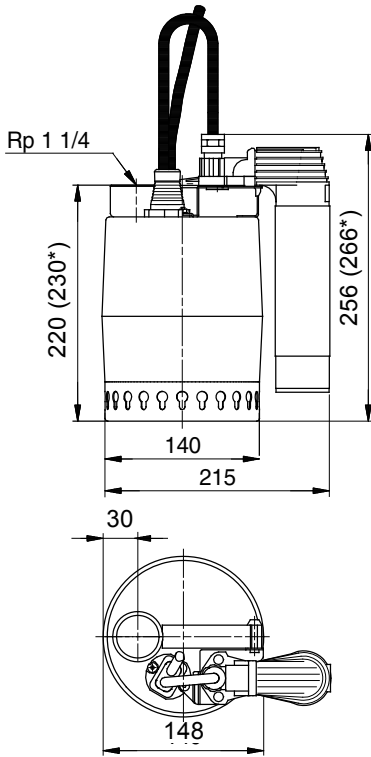

* Unilift KP 350

Unilift KP-M

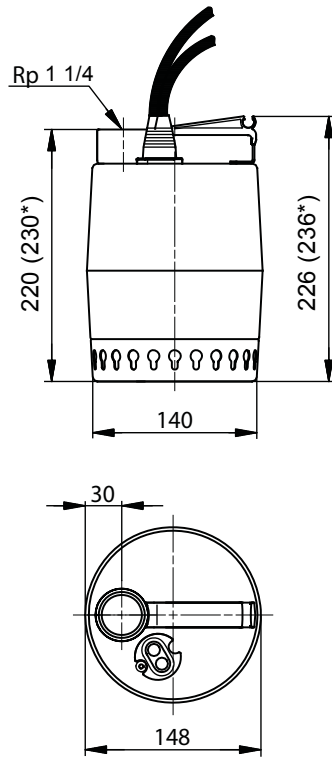

TM01 1523 4502

TM00 1642 1093

Argentina

Bombas GRUNDFOS de Argentina S.A.
Ruta Panamericana km. 37.500 Centro
Industrial Garin
1619 Garin Pcia. de B.A.
Phone: +54-3327 414 444
Telefax: +54-3327 45 3190

Australia

GRUNDFOS Pumps Pty. Ltd.
P.O. Box 2040
Regency Park
South Australia 5942
Phone: +61-8-8461-4611
Telefax: +61-8-8340 0155

Austria

GRUNDFOS Pumpen Vertrieb
Ges.m.b.H.
Grundfosstraße 2
A-5082 Grödig/Salzburg
Tel.: +43-6246-883-0
Telefax: +43-6246-883-30

Belgium

N.V. GRUNDFOS Bellux S.A.
Boomsesteenweg 81-83
B-2630 Aartselaar
Tél.: +32-3-870 7300
Télécopie: +32-3-870 7301

Belarus

Представительство ГРУНДФОС в
Минске
220125, Минск
ул. Шафарнянская, 11, оф. 56, БЦ
«Порт»
Тел.: +7 (375 17) 286 39 72/73
Факс: +7 (375 17) 286 39 71
E-mail: minsk@grundfos.com

Bosnia and Herzegovina

GRUNDFOS Sarajevo
Zmaj od Bosne 7-7A,
BH-71000 Sarajevo
Phone: +387 33 592 480
Telefax: +387 33 590 465
www.ba.grundfos.com
e-mail: grundfos@bih.net.ba

Brazil

BOMBAS GRUNDFOS DO BRASIL
Av. Humberto de Alencar Castelo
Branco, 630
CEP 09850 - 300
São Bernardo do Campo - SP
Phone: +55-11 4393 5533
Telefax: +55-11 4343 5015

Bulgaria

Grundfos Bulgaria EOOD
Slatina District
Iztochna Tangenta street no. 100
BG - 1592 Sofia
Tel. +359 2 49 22 200
Fax. +359 2 49 22 201
email: bulgaria@grundfos.bg

Canada

GRUNDFOS Canada Inc.
2941 Brighton Road
Oakville, Ontario
L6H 6C9
Phone: +1-905 829 9533
Telefax: +1-905 829 9512

China

GRUNDFOS Pumps (Shanghai) Co. Ltd.
10F The Hub, No. 33 Suhong Road
Minhang District
Shanghai 201106
PRC
Phone: +86 21 612 252 22
Telefax: +86 21 612 253 33

COLOMBIA

GRUNDFOS Colombia S.A.S.
Km 1.5 vía Siberia-Cota Conj. Potrero
Chico,
Parque Empresarial Arcos de Cota Bod.
1A.
Cota, Cundinamarca
Phone: +57(1)-2913444
Telefax: +57(1)-8764586

Croatia

GRUNDFOS CROATIA d.o.o.
Buzinski prilaz 38, Buzin
HR-10010 Zagreb
Phone: +385 1 6595 400
Telefax: +385 1 6595 499
www.hr.grundfos.com

GRUNDFOS Sales Czechia and Slovakia s.r.o.

Čajkovského 21
779 00 Olomouc
Phone: +420-585-716 111

Denmark

GRUNDFOS DK A/S
Martin Bachs Vej 3
DK-8850 Bjerringbro
Tlf.: +45-87 50 50 50
Telefax: +45-87 50 51 51
E-mail: info_GDK@grundfos.com
www.grundfos.com/DK

Estonia

GRUNDFOS Pumps Eesti OÜ
Peterburi tee 92G
11415 Tallinn
Tel: + 372 606 1690
Fax: + 372 606 1691

Finland

OY GRUNDFOS Pumput AB
Trukkikuja 1
FI-01360 Vantaa
Phone: +358-(0) 207 889 500

France

Pompes GRUNDFOS Distribution S.A.
Parc d'Activités de Chesnes
57, rue de Malacombe
F-38290 St. Quentin Fallavier (Lyon)
Tél.: +33-4 74 82 15 15
Télécopie: +33-4 74 94 10 51

Germany

GRUNDFOS GMBH
Schlüterstr. 33
40699 Erkrath
Tel.: +49-(0) 211 929 69-0
Telefax: +49-(0) 211 929 69-3799
e-mail: infoservice@grundfos.de
Service in Deutschland:
e-mail: kundendienst@grundfos.de

Greece

GRUNDFOS Hellas A.E.B.E.
20th km. Athinon-Markopoulou Av.
P.O. Box 71
GR-19002 Peania
Phone: +0030-210-66 83 400
Telefax: +0030-210-66 46 273

Hong Kong

GRUNDFOS Pumps (Hong Kong) Ltd.
Unit 1, Ground floor
Siu Wai Industrial Centre
29-33 Wing Hong Street &
68 King Lam Street, Cheung Sha Wan
Kowloon
Phone: +852-27861706 / 27861741
Telefax: +852-27858664

Hungary

GRUNDFOS Hungária Kft.
Park u. 8
H-2045 Törökbálint,
Phone: +36-23 511 110
Telefax: +36-23 511 111

India

GRUNDFOS Pumps India Private
Limited
118 Old Mahabalipuram Road
Thoraipakkam
Chennai 600 096
Phone: +91-44 2496 6800

Indonesia

PT. GRUNDFOS POMPA
Graha Intirub Lt. 2 & 3
Jln. Cililitan Besar No.454. Makasar,
Jakarta Timur
ID-Jakarta 13650
Phone: +62 21-469-51900
Telefax: +62 21-460 6910 / 460 6901

Ireland

GRUNDFOS (Ireland) Ltd.
Unit A, Merrywell Business Park
Ballymount Road Lower
Dublin 12
Phone: +353-1-4089 800
Telefax: +353-1-4089 830

Italy

GRUNDFOS Pompe Italia S.r.l.
Via Gran Sasso 4
I-20060 Truccazzano (Milano)
Tel.: +39-02-95838112
Telefax: +39-02-95309290 / 95838461

Japan

GRUNDFOS Pumps K.K.
1-2-3, Shin-Miyakoda, Kita-ku,
Hamamatsu
431-2103 Japan
Phone: +81 53 428 4760
Telefax: +81 53 428 5005

Korea

GRUNDFOS Pumps Korea Ltd.
679 Floor, Aju Building 679-5
Yeoksam-dong, Kangnam-ku, 135-916
Seoul, Korea
Phone: +82-2-5317 600
Telefax: +82-2-5633 725

Latvia

SIA GRUNDFOS Pumps Latvia
Deglava biznesa centrs
Augusta Deglava iela 60, LV-1035, Rīga,
Tālr.: + 371 714 9640, 7 149 641
Faks: + 371 914 9646

Lithuania

GRUNDFOS Pumps UAB
Smolensko g. 6
LT-03201 Vilnius
Tel: + 370 52 395 430
Fax: + 370 52 395 431

Malaysia

GRUNDFOS Pumps Sdn. Bhd.
7 Jalan Peguam U1/25
Glenmarie Industrial Park
40150 Shah Alam
Selangor
Phone: +60-3-5569 2922
Telefax: +60-3-5569 2866

Mexico

Bombas GRUNDFOS de México S.A. de
C.V.
Boulevard TLC No. 15
Parque Industrial Stiva Aeropuerto
Apodaca, N.L. 66600
Phone: +52-81-8144 4000
Telefax: +52-81-8144 4010

Netherlands

GRUNDFOS Netherlands
Veluwezoom 35
1326 AE Almere
Postbus 22015
1302 CA ALMERE
Tel.: +31-88-478 6336
Telefax: +31-88-478 6332
E-mail: info_gnl@grundfos.com

New Zealand

GRUNDFOS Pumps NZ Ltd.
17 Beatrice Tinsley Crescent
North Harbour Industrial Estate
Albany, Auckland
Phone: +64-9-415 3240
Telefax: +64-9-415 3250

Norway

GRUNDFOS Pumper A/S
Strømsveien 344
Postboks 235, Leirdal
N-1011 Oslo
Tlf.: +47-22 90 47 00
Telefax: +47-22 32 21 50

Poland

GRUNDFOS Pompy Sp. z o.o.
ul. Klonowa 23
Baranowo k. Poznania
PL-62-081 Przeźmierowo
Tel: (+48-61) 650 13 00
Fax: (+48-61) 650 13 50

Portugal

Bombas GRUNDFOS Portugal, S.A.
Rua Calvet de Magalhães, 241
Apartado 1079
P-2770-153 Paço de Arcos
Tel.: +351-21-440 76 00
Telefax: +351-21-440 76 90

Romania

GRUNDFOS Pompe România SRL
Bd. Biruintei, nr 103
Pantelimon county Ilfov
Phone: +40 21 200 4100
Telefax: +40 21 200 4101
E-mail: romania@grundfos.ro

Russia

ООО Грундфос Россия
Shkolnaya, 39-41
Москва, RU-109544, Russia
Тел. (+7) 495 564-88-00 (495) 737-30-00
Факс (+7) 495 564 88 11
E-mail grundfos.moscow@grundfos.com

Serbia

Grundfos Srbija d.o.o.
Omladinskih brigada 90b
11070 Novi Beograd
Phone: +381 11 2258 740
Telefax: +381 11 2281 769
www.rs.grundfos.com

Singapore

GRUNDFOS (Singapore) Pte. Ltd.
25 Jalan Tukang
Singapore 619264
Phone: +65-6681 9688
Telefax: +65-6681 9689

Slovakia

GRUNDFOS s.r.o.
Prievozská 4D
821 09 BRATISLAVA
Phona: +421 2 5020 1426
sk.grundfos.com

Slovenia

GRUNDFOS LJUBLJANA, d.o.o.
Leskovoška 9e, 1122 Ljubljana
Phone: +386 (0) 1 568 06 10
Telefax: +386 (0) 1 568 06 19
E-mail: tehnika-si@grundfos.com

South Africa

GRUNDFOS (PTY) LTD
Corner Mountjoy and George Allen
Roads
Wilbart Ext. 2
Bedfordview 2008
Phone: (+27) 11 579 4800
Fax: (+27) 11 455 6066
E-mail: lsmart@grundfos.com

Spain

Bombas GRUNDFOS España S.A.
Camino de la Fuentequilla, s/n
E-28110 Algete (Madrid)
Tel.: +34-91-848 8800
Telefax: +34-91-628 0465

Sweden

GRUNDFOS AB
Box 333 (Lunnagårdsgatan 6)
431 24 Mölndal
Tel.: +46 31 332 23 000
Telefax: +46 31 331 94 60

Switzerland

GRUNDFOS Pumpen AG
Bruggacherstrasse 10
CH-8117 Fällanden/ZH
Tel.: +41-44-806 8111
Telefax: +41-44-806 8115

Taiwan

GRUNDFOS Pumps (Taiwan) Ltd.
7 Floor, 219 Min-Chuan Road
Taichung, Taiwan, R.O.C.
Phone: +886-4-2305 0868
Telefax: +886-4-2305 0878

Thailand

GRUNDFOS (Thailand) Ltd.
92 Chaloeang Phrakiat Rama 9 Road,
Dokmai, Pravej, Bangkok 10250
Phone: +66-2-725 8999
Telefax: +66-2-725 8998

Turkey

GRUNDFOS POMPA San. ve Tic. Ltd.
Sti.
Gebze Organize Sanayi Bölgesi
İhsan dede Caddesi,
2. yol 200. Sokak No. 204
41490 Gebze/ Kocaeli
Phone: +90 - 262-679 7979
Telefax: +90 - 262-679 7905
E-mail: satis@grundfos.com

Ukraine

Бізнес Центр Європа
Столичне шосе, 103
м. Київ, 03131, Україна
Телефон: (+38 044) 237 04 00
Факс.: (+38 044) 237 04 01
E-mail: ukraine@grundfos.com

United Arab Emirates

GRUNDFOS Gulf Distribution
P.O. Box 16768
Jebel Ali Free Zone
Dubai
Phone: +971 4 8815 166
Telefax: +971 4 8815 136

United Kingdom

GRUNDFOS Pumps Ltd.
Grovebury Road
Leighton Buzzard/Beds. LU7 4TL
Phone: +44-1525-850000
Telefax: +44-1525-850011

U.S.A.

GRUNDFOS Pumps Corporation
17100 West 118th Terrace
Olathe, Kansas 66061
Phone: +1-913-227-3400
Telefax: +1-913-227-3500

Uzbekistan

Grundfos Tashkent, Uzbekistan The Rep-
resentative Office of Grundfos Kazakhstan
in Uzbekistan
38a, Oybek street, Tashkent
Телефон: (+998) 71 150 3290 / 71 150
3291
Факс: (+998) 71 150 3292

Addresses Revised 07.06.2017

be think innovate

96894217 0417

ECM: 1206635

The name Grundfos, the Grundfos logo, and **be think innovate** are registered trademarks owned by Grundfos Holding A/S or Grundfos A/S, Denmark. All rights reserved worldwide.
© Copyright Grundfos Holding A/S

www.grundfos.com

GRUNDFOS 